

## KWC SUNO Lever mixer - Kitchen

Modell-Linie: SUNO | 10.171.023.000FL  
Taps | Manual taps

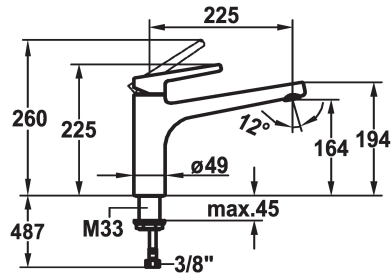

### KWC-No.

**123952**  
chromeline, A 225, flexible connection hoses

- \* Lever mixer
- \* Swivel spout 160°
- Neoperl® Cascade®
- \* KWC cartridge M 35 H
- with ceramic discs

- flow rate and temperature continuously variable
- \* Flexible connection hoses 3/8"
- \* Fastening by means of threaded sleeve M33 x 1.5
- \* Mounting hole size  $\varnothing 35$  mm

### Technical Data

Flow rate	12 l/min (3 bar)
Connection	Flexible connection hoses
Spout	swivel
Handling	top lever
Color code	chrome
Installation_type	Pillar installation
Faucet_typ	Lever mixer
Dimension Height	225
G_Acoustic group	I
Projection_A	A 225
Energy Label	B
Dimension Water outlet	164
material	Brass

Flow rate	12 l/min (3 bar)
Connection	Flexible connection hoses
Spout	swivel
Handling	top lever
Color code	chrome
Installation_type	Pillar installation
Faucet_typ	Lever mixer
Dimension Height	225
G_Acoustic group	I
Projection_A	A 225
Energy Label	B
Dimension Water outlet	164
material	Brass



### Spare Parts





**KWC** SUNO  
Lever mixer - Kitchen

**Modell-Linie: SUNO | 10.171.023.000FL**  
Taps | Manual taps

**Cartridge M 35 H**

---

**538327**  
Z.537.582

---