

KWC SUNO Lever mixer - Kitchen

Modell-Linie: SUNO | 10.171.023.000FL
Taps | Manual taps

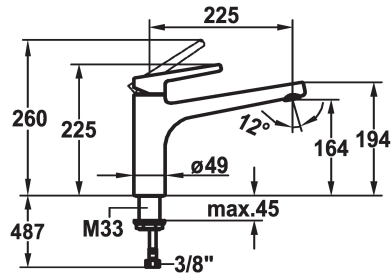

KWC-No.

123952
chromeline, A 225, flexible connection hoses

- * Lever mixer
- * Swivel spout 160°
- Neoperl® Cascade®
- * KWC cartridge M 35 H
- with ceramic discs

- flow rate and temperature continuously variable
- * Flexible connection hoses 3/8"
- * Fastening by means of threaded sleeve M33 x 1.5
- * Mounting hole size $\varnothing 35$ mm

Technical Data

Flow rate	12 l/min (3 bar)
Connection	Flexible connection hoses
Spout	swivel
Handling	top lever
Color code	chromeline
Installation type	Pillar installation
Faucet_typ	Lever mixer
Dimension Height	225
Acoustic group	I
Projection A	A 225
Energy label	B
Dimension Water outlet	164
material	Brass

Flow rate	12 l/min (3 bar)
Connection	Flexible connection hoses
Spout	swivel
Handling	top lever
Color code	chromeline
Installation type	Pillar installation
Faucet_typ	Lever mixer
Dimension Height	225
Acoustic group	I
Projection A	A 225
Energy label	B
Dimension Water outlet	164
material	Brass



Spare Parts





KWC SUNO
Lever mixer - Kitchen

Modell-Linie: SUNO | 10.171.023.000FL
Taps | Manual taps

Cartridge M 35 H

538327
Z.537.582
