

## KWC SUNO Lever mixer - Kitchen

Modell-Linie: SUNO | 10.171.023.000FL  
Kranar | Hydraulické armatúry

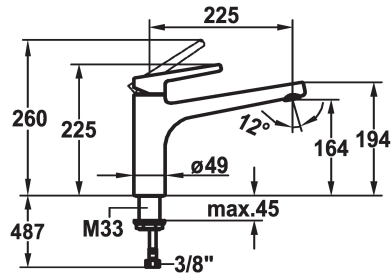

### KWC-No.

**123952**

chromeline, A 225, flexible connection hoses

- \* Lever mixer
- \* Swivel spout 160°
- Neoperl® Cascade®
- \* KWC cartridge M 35 H
- with ceramic discs

- flow rate and temperature continuously variable
- \* Flexible connection hoses 3/8"
- \* Fastening by means of threaded sleeve M33 x 1.5
- \* Mounting hole size ø35 mm

### Technical Data

A_Spout_Spray
Connection
ATT-KWC-AUSLAUF
Handling
ATT-KWC-FARBCODE
Installation_type
Faucet_typ
Measure_Height
G_Acoustic group
Projection_A
EnergyLabelCH
ATT-KWC-MASS-WASSERAUSTRITT
Material

12 l/min (3 bar)
Flexible_Anschlusschläuche
schwenkbar
topbedient
chromeline
Standmontage
Hebelmischer
225
I
A225
B
164
Mässing



### Reservdelar





**KWC** SUNO  
Lever mixer - Kitchen

**Modell-Linie: SUNO | 10.171.023.000FL**  
Kranar | Hydraulické armatury

**Cartridge M 35 H**

---

**538327**  
Z.537.582

---