

KWC RODAN Toilet roll holder for wall mounting

Modell-Linie: RODAN | RODX672
Accessories | WC-roll holders

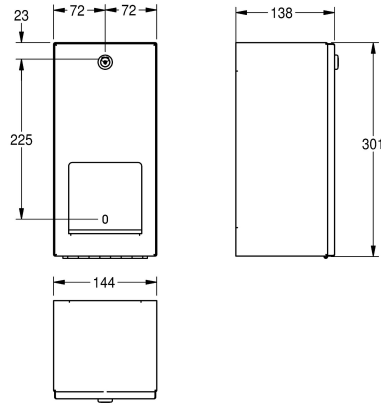

KWC-No.

2000090072

Dimensions 144 x 301 x 138 mm (W x H x D)

Double toilet roll holder with spindle system for wall mounting, stainless steel, surface satin finished, material thickness 0.8 mm, folded front cover, cylinder lock with KWC standard key, for 2 rolls with max. diameter 120 mm, second roll will be released after

consumption of first roll, with spindles, reserve roll not visible, includes stainless steel screws and dowels.

Dimensions 144 x 301 x 138 mm (W x H x D)

Technical Data

maximum depth/diameter of cons	115 mm
maximum width of consumable	115 mm
filling quantity	2
filling quantity uom	rolls
lock	key-lock
material	stainless steel
material code	1.4301 Chrome Nickel steel V2A
material thickness	0.8 mm
overall depth	138 mm
overall height	301 mm
overall width	144 mm
spindle	Yes
surface finish	satin finished
type of fixing	screw
type of mounting	wall mounting