

KWC ANIMA Single washbasin

Modell-Linie: ANIMA | CM700
Washbasins & Washtroughs | Wash basins

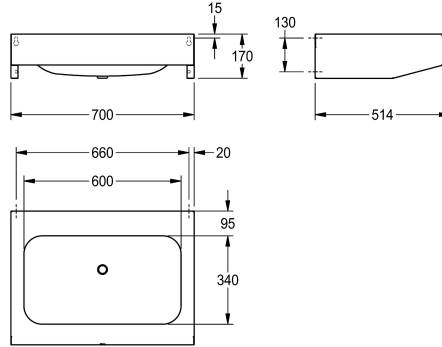

KWC-No.

2000100039

Dimensions 700 x 170 x 514 mm (W x H x D) with 1 washbasin

Wash basin, stainless steel, surface satin finished, material thickness 1.0 mm, with tap ledge 95 mm, without tap hole, waste G 1 1/2 B, includes screws and dowels.

1 basin
Dimensions 700 x 170 x 514 mm (W x H x D)
Bowl Dimensions 600 x 130 x 340 mm (W x H x D)

Technical Data

type of basin	Wash basin
bowl position	Center
bowl - bowl height	130 mm
bowl finish	satin finished
bowl - depth	340 mm
bowl shape	rounded rectangle
bowl - width	600 mm
colour	no colour
material	stainless steel
material code	1.4301 Chrome Nickel steel V2A
material thickness	1 mm
overall depth	514 mm
overall height	170 mm
overall width	700 mm
overflow	no
rear upstand	no
siphon diameter	DN 40
siphon included	no
spillway	no
splash back	no
surface finish	satin finished
tap ledge	yes
type of mounting	wall mounting
type of waste kit	flat perforated waste
waste hole position	centre back
waste hole projection	225 mm

Wash basin
Center
130 mm
satin finished
340 mm
rounded rectangle
600 mm
no colour
stainless steel
1.4301 Chrome Nickel steel V2A
1 mm
514 mm
170 mm
700 mm
no
no
DN 40
no
no
no
satin finished
yes
wall mounting
flat perforated waste
centre back
225 mm





KWC ANIMA
Single washbasin

Modell-Linie: ANIMA | CM700
Washbasins & Washtroughs | Wash basins

waste kit included	yes
waste size	DN 40
waste sleeve included	no