

## KWC HEAVY-DUTY WC washbasin combination

Modell-Linie: HEAVYDUTY | HDTX815R  
Heavy Duty | Prison units

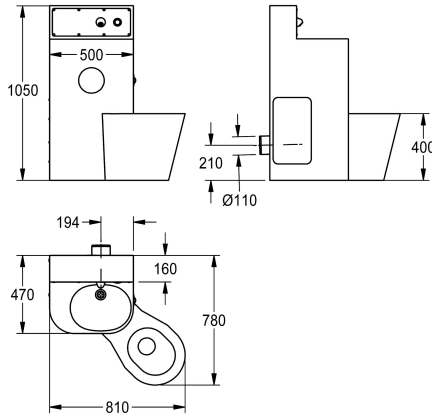

### KWC-No.

#### 2000100965

Version with WC pan angled 45° to the left

#### 2000100966

Version with centrally arranged WC pan Dimensions 500 x 1050 x 890 mm (W x H x D)

#### 2000100967

Version with WC pan angled 45° to the right Dimensions 809 x 1050 x 779 mm (W x H x D)

### WC position

left

middle

right

Chromium nickel steel WC wash basin combination, satin finish surface for installing against a wall, invisible fixing with grub screws, lockable inspection opening. Mounting stand, material thickness 2 mm with elevated rear wall including wall outlet and press button operation, seamless welded toilet paper roll compartment and seamless moulded oval wash basin with plastic trap. WC pan, material thickness 1.6 mm with full-length skirting, arranged on the right 45 degrees, bowl rim where nothing can hide,

flushing certified pursuant to EN 997, horizontal outlet at the back DN 100. Self-closing gate valve with remote control to connect to premixed hot water or cold water, closing automatically with no blow back. Condensation water-proof concealed cistern with single flush technology (9 or 6 litres) Including fixing material.

Overall dimensions 809 x 1050 x 779 mm (W x H x D)  
WC position on the right

### Technical Data

|                             |                                |
|-----------------------------|--------------------------------|
| body width                  | 500 mm                         |
| front access panel          | Yes                            |
| floor fixing joggle plate   | No                             |
| inlet size                  | DN 15                          |
| material                    | stainless steel                |
| material code               | 1.4301 Chrome Nickel steel V2A |
| material thickness body     | 2 mm                           |
| material thickness WC       | 1.5 mm                         |
| outlet size                 | DN 50 / DN 100                 |
| overall depth               | 780 mm                         |
| overall height              | 1,050 mm                       |
| overall width               | 810 mm                         |
| overflow                    | No                             |
| pipework material           | stainless steel                |
| self closing push buttons   | mechanical                     |
| toilet roll holder diameter | 153 mm                         |
| shroud design               | angled corners                 |
| soap dish                   | No                             |
| spout length                | 83 mm                          |





**KWC HEAVY-DUTY**  
WC washbasin combination

**Modell-Linie: HEAVYDUTY | HDTX815R**  
Heavy Duty | Prison units

|                             |                |
|-----------------------------|----------------|
| surface finish              | satin finished |
| tap with integrated bubbler | No             |
| type of flushing fitting    | WC cistern     |
| type of mounting            | wall mounting  |
| type of toilet seat         | no seat        |
| type of WC                  | floor standing |
| upper edge of basin height  | 850 mm         |
| upstand depth               | 160 mm         |
| upstand height              | 200 mm         |
| WC height                   | 400 mm         |
| WC position                 | right          |