

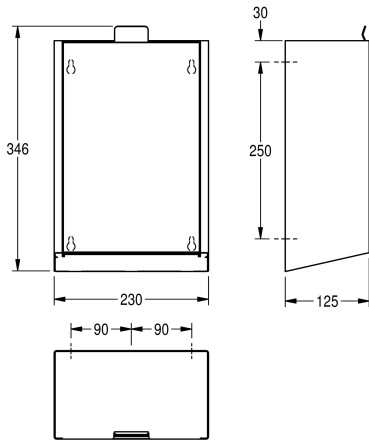

KWC EXOS.
Hygiene waste bin for wall mounting

Modell-Linie: EXOS | EXOS611X
Accessories | Hygiene bins

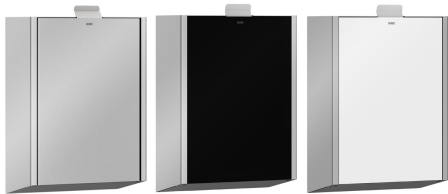

KWC-No.
2030028001
Front with InoxPlus surface refinement
2030030108
InoxPlus-coated main housing, black toughened safety glass front panel
2030030111
InoxPlus-coated main housing, white toughened safety glass front panel

Accent colour
stainless steel-look
black
white

Hygiene waste bin for wall mounting, stainless steel with satin finish and InoxPlus surface refinement for the reduction of finger marks and better cleaning characteristics (easy to clean), material thickness 1.2 mm, capacity approx. 3.7 litres, hinged self-closing

front, integrated plastic container for waste removal, includes mounting materials.
Dimensions 230 x 346 x 125 mm (W x H x D)

Technical Data
bag holder
filling volume
lid
lock
material
material code
material thickness
overall depth
overall height
overall width
surface treatment
type of fixing
type of mounting
Accent colour
Basic colour

No
3.7 Liter
Yes
no lock
stainless steel
1.4301 Chrome Nickel steel V2A
1.2 mm
125 mm
346 mm
230 mm
InoxPlus (anti fingerprint)
screw
wall mounting
stainless steel-look
stainless steel-look



Optional Accessories



KWC EXOS.
Hygiene waste bin for wall mounting

Modell-Linie: **EXOS | EXOS611X**
Accessories | Hygiene bins



EXOS. front with black safety glass panel

2030034650
ZEXOS611B



EXOS. front with white safety glass panel

2030034707
ZEXOS611W