

## KWC EXOS. Hand dryer

Modell-Linie: EXOS | EXOS220B  
Hand and hair dryers | Hand dryers

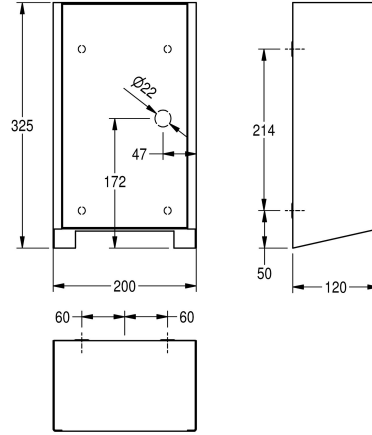

### KWC-No.

#### 2030027981

Front with InoxPlus surface refinement

#### 2030034622

InoxPlus-coated main housing, black toughened safety glass front panel

#### 2030034660

InoxPlus-coated main housing, white toughened safety glass front panel

### Accent colour

stainless steel

black

white

Hand dryer for wall mounting, stainless steel with satin-finish, black safety glass front panel and casing with InoxPlus surface refinement for the reduction of finger marks and better cleaning characteristics (easy to clean), material thickness 1.2 mm, with contactless opto-electronic sensor for touch-free operation, adjustable hot air temperature, sensor range adjustable from 10 to 25 cm, protection from continuous operation with automatic switch-off after 60 seconds, air speed adjustable, cable and plug not included.

Operating voltage 220-240V AC, 50-60 Hz  
Total power 800-1000 W  
Heater 500 W  
Motor 500 W  
Air volume 80 m<sup>3</sup>/h  
Air velocity 95 - 115 m/s

Dimensions 200 x 325 x 120 mm (W x H x D)

### Technical Data

air velocity
blower output
input supply voltage Hz
input supply voltage V
input supply voltage V max
input supply voltage V min
heating power
material
material code
material thickness
motor power
overall depth
overall height
overall width
protective system IP
sound level
surface treatment
total power
type of fixing

adjustable
80 Cubic Meter/Hour
50 Hertz (1/second)
220 Volt
240 Volt
220 Volt
500 Watt
stainless steel
1.4301 Chrome Nickel steel V2A
1.2 mm
500 Watt
120 mm
325 mm
200 mm
IPX1
76.2 Decibels (A Weighting)
InoxPlus (anti fingerprint)
1,000 Watt
screw

## KWC EXOS. Hand dryer

Modell-Linie: EXOS | EXOS220B  
Hand and hair dryers | Hand dryers

type of mounting  
type of operation  
Accent colour

wall mounting  
sensor operation  
black

### Optional Accessories



Interchangeable front panels for  
EXOS. hand dryers

**2030035358**  
ZEXOS220



EXOS. front cover with white safety  
glass panel

**2030035360**  
ZEXOS220W